

## Hub Puller [LGV] & 12-Ton Hydraulic Ram



### Information

---

- Set comes complete with a 12 ton hydraulic ram suitable for any task you will come across.
- Specifically designed for use on hubs with 4, 5, and 6 holes.
- Pin Hole Maximum Outer Range: 137-175mm.
- Universal hole alignment system.
- For wheel bolts up to M14.

### Precautions

---

Always wear safety gear.  
Working in a clean and safe environment.  
This task should be carried out by trained personnel.  
Make sure to consult manufacturers manual.  
Do NOT use with air tools.

## Applications

---

- Applications Include:
- Citroen: Jump Dispatch, Jumper and Relay.
- Fiat: Ducato Iveco Daily 2, Daily 3.
- Mercedes-Benz: Sprinter, Vito.
- Vauxhall: Movano, Vivaro.
- Peugeot: Boxer, Expert.
- Renault: Master, Trafic.
- Ford: Transit.

## Instructions

---

### Step 1

After removing the wheel using the existing studs from the vehicle, insert them into their corresponding holes depending on the model of your vehicle.

### Step 2

When the studs are in place and secured to the hub, insert the hydraulic spindle onto the puller base with the adapter included.

### Step 3

Note: It is recommended that the spindle be well lubricated. Slowly turn the spindle clockwise. The hub assembly should start to pry away from the main body.

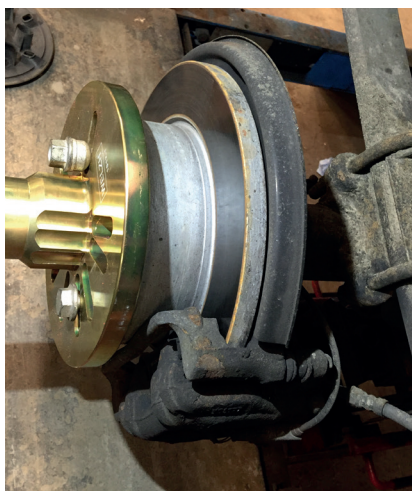
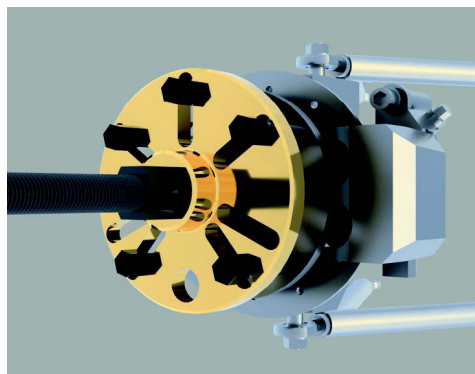
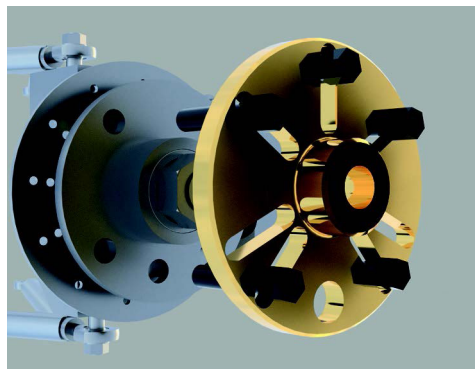

## Warranty

---

If you are unsure on how to use the item please contact us. If it were to fail due to a manufacturing fault or poor workmanship we will repair or replace it. Please contact your local dealer in the event you need to send the item back. You can also make a repair/replacement request on our website and download & complete the form online. Normal wear and tear along with misuse will void any warranty. Consumables are not covered under warranty.

[www.welzh.com](http://www.welzh.com)

Limited **12 month** warranty



Welzh Werkzeug Ltd.  
Loanwath Road  
Gretna, Scotland  
DG16 5HD  
+44 (0)1461 700120