

Air Installation Tool For CV Boot + Model



Information

- For the installation of CV boots without removing the drive shaft.
- New + Model allows use on the more popular larger sized boots.
- Jaw opening now to a maximum of 150mm.
- New ergonomic handle design with built in hand guard.
- Saves huge amounts of time compared to traditional methods.
- Maximum Air Pressure: 116 PSI.
- Joint Diameter: 150mm.
- Air Inlet: 1/4" BSP.
- Weight: 2 kg.
- Operating air pressure: 4-8 bar (maximum 9 bar).
- Noise level: <70 dB(A).
- Vibration level: <2.5 m/s².
- In accordance with BS EN ISO/IEC 17050-1:2010.

Precautions

Always wear safety gear.
Working in a clean and safe environment.
This task should be carried out by trained personnel.
Make sure to consult manufacturers manual.
Do NOT use with air tools.



Wear Safety Gloves



Wear Safety Glasses



Read Instructions



**Maximum Pressure
9 bar [130 psi]**

Safety and Precautions

- Users must be properly trained to operate pneumatic devices.
- Observe the safety guidelines as air hoses are dangerous.
- Ensure the vehicle is properly supported with the wheels secured.
- Wear safety gloves while operating and keep hands away from moving parts.
- Wear safety glasses while operating and do NOT operate near the face.
- The maximum safe operating pressure is 9 bar (130 psi). Fit a regulator to ensure pressure is within this range.
- A safety pressure valve is installed. A leaking sound will be heard from the piston when operating.
- Do NOT use for any other use than to fit stretchy CV boots.
- Support the main body of the device with your free hand during the expansion of the CV boot.
- Store the device and manual safely.
- Wipe clean after use.
- Properly dispose of any contaminated cleaning materials in line with local waste disposal guidance.

Instructions

Step 1

- Connect the appropriate adaptor to the body. The maximum torque is 2.3 Nm. It fits a BSP 1/4" male thread.

Step 2

- Ensure the air pressure does not go over 9 bar (130 psi). Fit a regulator to bring the pressure within range.
- NOTE: The maximum torque is 9 Nm.

Step 3

- When the tool is disconnected from the air hose, check that the cap-retaining nuts and bolts are securely fixed in place. Check for any visible signs of damage before performing the next steps. If there are any, do NOT operate. Using a damaged CV boot may cause it to be forcefully ejected during expansion.

Step 4

- Carefully slide the CV boot onto the metal fingers with the large end first. Settle the boot as far as you can onto the fingers so that they just protrude from the small end of the boot (1).
- To fit the CV boot to an inner joint; slide the CV boot onto the metal fingers with the small end first. Pull the large end down the metal fingers until the CV boot is the other way round.

Step 5

- Connect to the air hose. It is recommended to use a safe flow quick release coupling.
- Press the air button (2) until the fingers are opened enough to pass over the joint. Keep hands away from moving parts.
- It is recommended to warm the boot prior to stretching for better results.
- Pre-stretch the boot a few times on the tool before fitting when fitting onto larger joints.

Step 6

- Disconnect from the air hose. The device cannot be used while it is connected.
- Carefully place the metal fingers and CV boot over the CV joint (3).
- The pneumatic opening is limited to a maximum of 125mm* to prevent boots from splitting. Manually expand the tool for larger joints by pushing it over the joint (up to a maximum of 155).

Step 7

- Keep hands away from moving parts. Press the air button (2).
- Slide the boot from the metal arms and withdraw.
- Complete the boot installation procedure as normal.

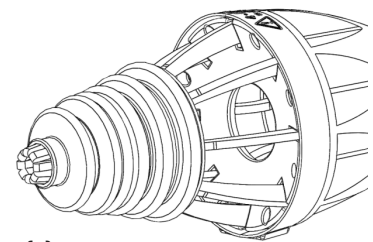

(1)

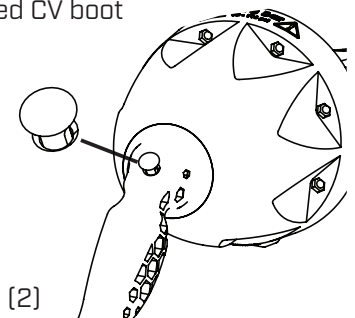

(2)

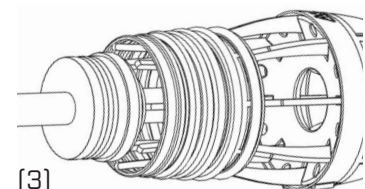

(3)

*Maximum opening depends on the boot being stretched and the boot temperature. A warmer boot is more pliable than a cool boot.

Warranty

If you are unsure on how to use the item please contact us. If it were to fail due to a manufacturing fault or poor workmanship we will repair or replace it. Please contact your local dealer in the event you need to send the item back. You can also make a repair/replacement request on our website and download & complete the form online. Normal wear and tear along with misuse will void any warranty. Consumables are not covered under warranty.

www.welzh.com

Limited **12 month** warranty



Welzh Werkzeug Ltd.
Loanwath Road
Gretna, Scotland
DG16 5HD
+44 (0)1461 700120