Professional Air Brake Bleeder &
Adaptor Set



Information

- Saves time as it uses compressed air allowing for multiple oil changes to be made simultaneously.
- For bleeding brakes and clutches for all ABS system vehicles.
- Working air pressure: 10-40 PSI.
- Air consumption: 4.5 CFM at 30 PSI.
- Tank Capacity: 5 Litres.
- Air Inlet: 1/4" Male coupler.

Precautions

Always wear safety gear.
Working in a clean and safe environment.
This task should be carried out by trained personnel.
Make sure to consult manufacturers manual.
Do NOT use with air tools.

Instructions

Step 1

Place vehicle on hoist or vehicle stand.
Set the brake and turn the engine off.

Step 2

Remove the wheels.
Refer to the vehicle's manual to locate the drain connection on brake cylinders.

Step 3

Switch on the air compressor.
Insert air hose into the break fluid exchanger as indicated in the image.

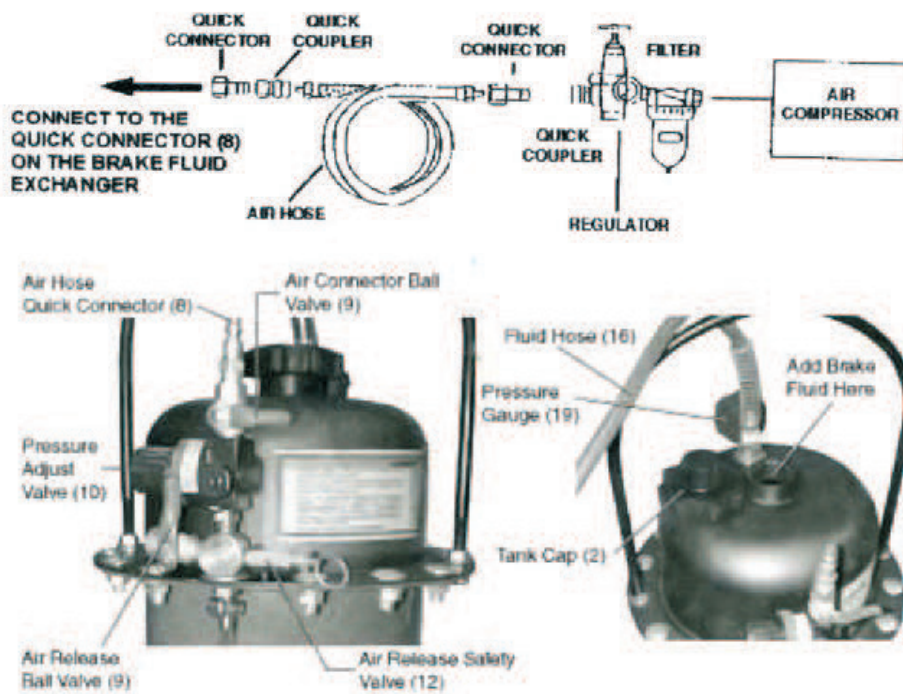

WARNING: The engine must not be started in a closed area as the carbon monoxide produced during the procedure is deadly.

Step 4

Remove the tank cap of the brake fluid exchanger [2].
Open the engine hood and remove the master cylinder lid..

Step 5

Use the list below to select the appropriate adapter from the adapter set and attach it to the master cylinder.

Step 6

Pour in the appropriate amount of new brake fluid into the tank of the brake fluid exchanger [2]. Consult the vehicle's manual for the required amount and type of fluid. Close the tank cap tightly when done.

Step 7

Connect the fluid hose's [16] quick connector with the adapter inserted onto the master cylinder. Ensure that the ball valve [9] is closed (sideways to the direction of the fluid hose).

Instructions

Step 8

Remove the drain screws from the rear brake cylinder.

Insert clear rubber tube into the drain holes.

Insert the rubber connector of the used fluid bottles into the other end of the rubber tube.

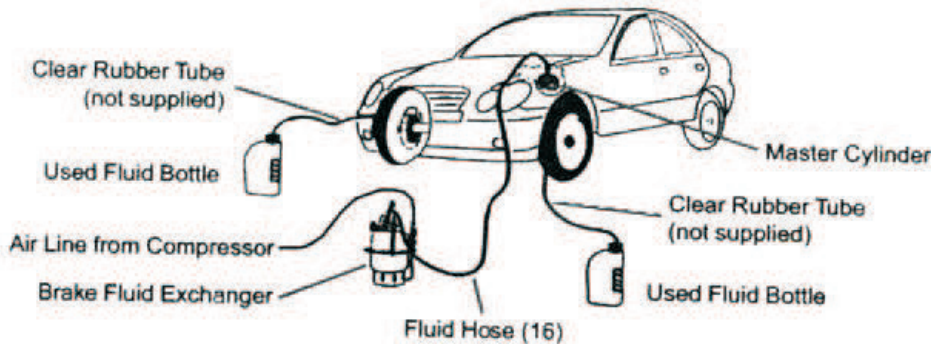

Step 9

Connect the air line hose to the air hose quick connector (8) on the brake fluid exchanger.

Switch the air connector ball valve (9) on in a vertical position.

Pull the pressure adjust valve (10) knob and turn it to adjust to the tank pressure between 20-40PSI. Do NOT exceed 40 PSI as it may damage the equipment and hoses.

Step 10

Slowly open the fluid hose (16) ball valve (9) on top of the master cylinder to allow the new fluid in. Check for leaks at all connection points.

Step 11

During the fluid transfer, quickly press onto the brake pedal and slowly release. Do this a few times.

Step 12

When the used fluid bottles are full or the fluid colour changes from dark to light, remove the connected bottles and rubber tubes and return the screws into the drain holes.

Safely dispose of the used fluid bottles.

Repeat steps 8 to 12 for the front brake cylinders.

When the task is completed turn the ball valve (9) on the master cylinder off sideways and remove the fluid hose (16) from the master cylinder.

Adding New Fluid to Vehicles with ABS Brake Systems

Follow the previous steps and:

- Remove the drain screw for one brake cylinder at a time, then drain that brake cylinder.
- Place the vehicle transmission in Park. Start the engine during this process. When the new fluid is added, switch the engine off.
- Remove the used fluid bottle and rubber tube connected to the brake cylinder and return the screw to the drain hole.

When The Task Is Completed

- Return the master cylinder lid in place.
- Remove the air input line from the air hose quick connector (8) on the tank.
- Open the air release ball valve (9) on the tank and pull the air release safety valve (12) to allow the tank to depressurize.
- Safely dispose of the used fluid bottles.
- Clean any brake fluid oil that may have spilled.
- Wipe the brake fluid exchanger components using a cloth.
- Store in a clean and dry place.

WARNING: Depress the brake pedal repeatedly before starting the vehicle until the brake pedal is firm. Check for leaks in the brake calipers. Test the brakes at a slow speed before using the vehicle on the road.

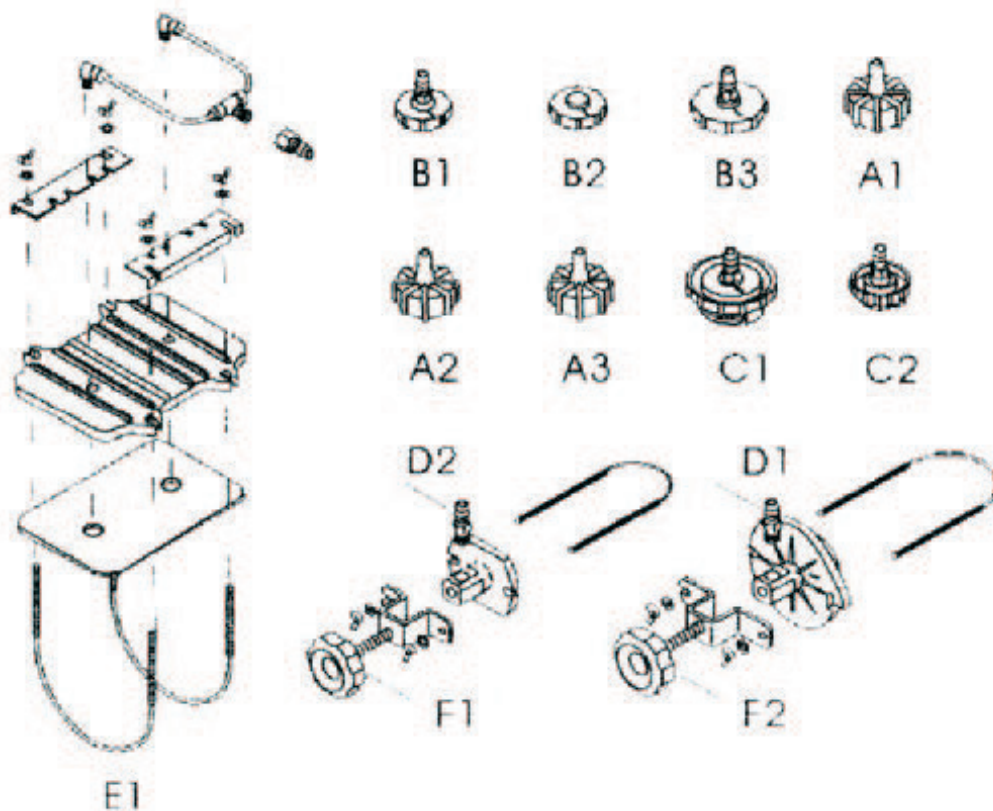

Warranty

If you are unsure on how to use the item please contact us. If it were to fail due to a manufacturing fault or poor workmanship we will repair or replace it. Please contact your local dealer in the event you need to send the item back. You can also make a repair/replacement request on our website and download & complete the form online. Normal wear and tear along with misuse will void any warranty. Consumables are not covered under warranty.

www.welzh.com

Limited **12 month** warranty



Welzh Werkzeug Ltd
Loanwath Road
Gretna, Scotland
DG16 5HD
+44 (0)1461 700120